

**PROJECT INFORMATION**  
**SITE AREA**

TOTAL ± 42.75 ACRES  
TOTAL SITE COVERAGE: 24.6% (10,694 SF/AC)

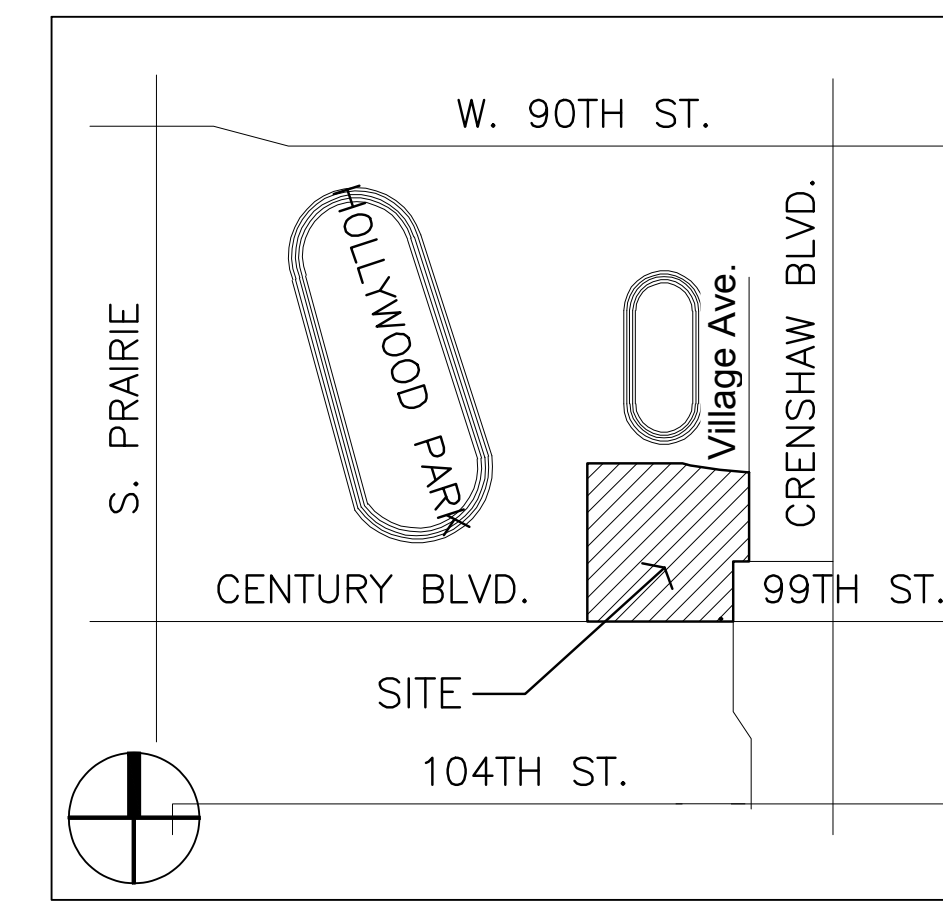

LOCATION MAP

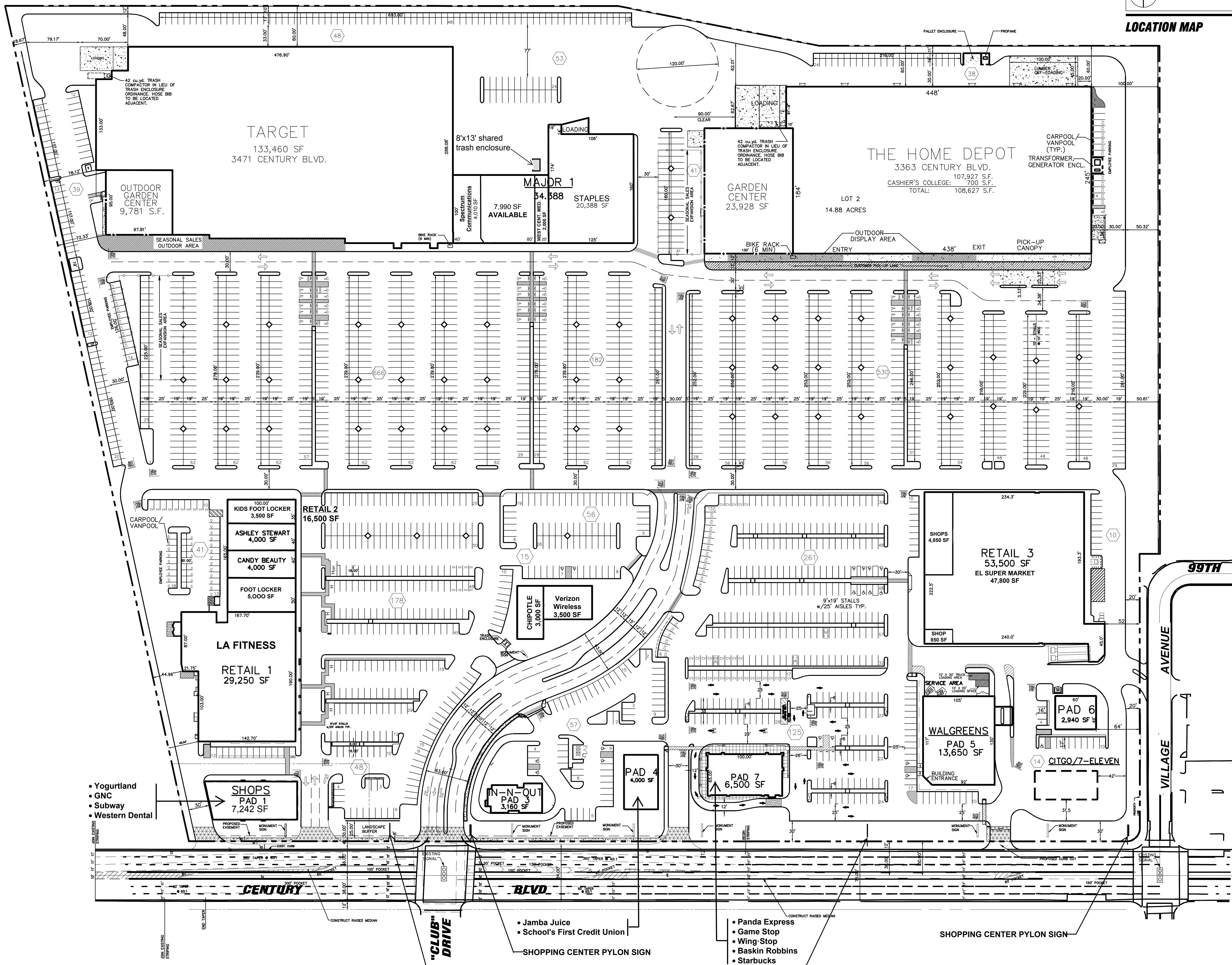

**BUILDING AREA**

THE HOME DEPOT (including GC.) 132,555 SF  
TARGET (including GC.) 143,241 SF

MAJOR 1 (STAPLES, SHOPS) 34,388 SF  
RETAIL 1 (LA FITNESS) 29,250 SF  
RETAIL 2 (SHOPS) 16,500 SF  
RETAIL 3 (EL SUPER/SHOPS) 53,500 SF

PAD 1 (SHOPS) 7,000 SF  
PAD 2 (SHOPS) 6,500 SF  
PAD 3 (IN-N-OUT) 3,160 SF  
PAD 4 (SHOPS) 4,000 SF  
PAD 5 (WALGREENS) 13,650 SF  
PAD 6 (CITGO/7-ELEVEN) 2,940 SF  
PAD 7 (SHOPS) 6,500 SF  
TOTAL 453,184 SF

**PARKING SUMMARY**

USER	RATIO REQUIRED	SPACES REQ'D	SPACES PROVIDED
HOME DEPOT, TARGET,	60 spaces for the first 14,000 SF 1/400 for the rest	714	1,418
MAJOR 1	1/400	426	927
PADS 1, 2, 5, 6, & 7	1/150	48	57
TOTAL		1,188	2,402

TOTAL RATIO PROVIDED 5.30 SP/1000 SF

**ZONING CLASSIFICATION**

C-R (COMMERCIAL RECREATIONAL)  
P.A.D. (PLANNED ASSEMBLY DEVELOPMENT)

- Yogurtland
- GNC
- Subway
- Western Dental

- Jamba Juice
- School's First Credit Union

- Panda Express
- Game Stop
- Wing-Stop
- Baskin Robbins
- Starbucks

SHOPPING CENTER PYLON SIGN

TENANT MONUMENT SIGNS

**THE MARKETPLACE AT HOLLYWOOD PARK**  
**INGLEWOOD, CA**  
CENTURY BLVD. & VILLAGE AVENUE

5/03/19

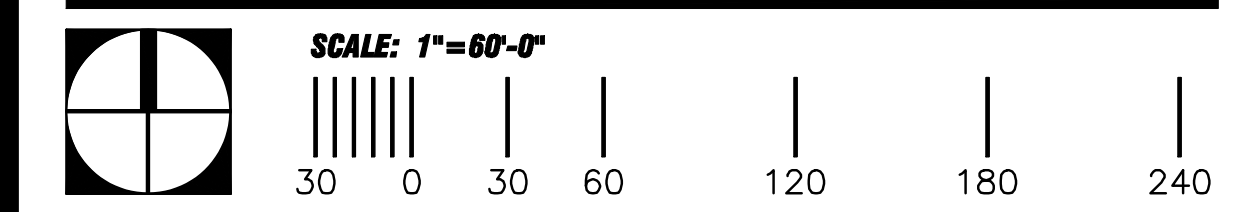

**THE MARKETPLACE AT HOLLYWOOD PARK**

Drawing Name: A:\PROJECTS\2009\2009060802\Inglewood\Marketplace\Site\77\_00-15.dwg, Last Modified: Jan 02, 2009 - 11:02am, Plotted on: Jul 16, 2009 - 3:08pm, by: [redacted]